

Submission ID: 301

Date: Apr 04 24 03:14:23 pm

Name:

Tui and Red Edwards

Organisation (if on behalf of organisation) of our whanau on Shaw Road

How should we scale, fund and stage necessary upgrades to the Rex Morpeth Recreation Hub?

Option 3: Carry out necessary upgrades to the Rex Morpeth Recreation Hub

Your thoughts on how should we scale, fund and stage necessary upgrades to the Rex Morpeth Recreation Hub:

Council need to secure and find all the funding without burdening the ratepayers.

How should we manage foodwaste collection?

Option 3: Separate foodwaste collection for all properties.

Your thoughts on how we should manage foodwaste collection:

Look at projects to make compost out of food waste?

How quickly should we close our funding gap?

Option 3: Close the gap in the medium-term (in six years) to ease the burden now.

Your thoughts on closing our funding gap:

Council need to be more considerate on the impact they will have on ratepayers in these difficult time people are struggling, cost of living crisis and not inflicting more increases in their cost of living by raising rates, need to look at cutting costs and unnecessary spending.

How should we distribute rates increases across the properties in our district?

Your thoughts on how we should distribute rates increases across the properties in our district:

Many low to medium income earners, ratepayers will struggle to pay all options.

Supporting document

Attached

Do you have any other feedback for your Mayor and Councillors?

Yes as detailed in my letter regarding object to Shaw Road - Mill Road roundabout connection please consider our objection, and put yourself in our shoes, you will devalue our property and make it very unsafe for us and our mokopuna, and the traffic noise will be unbearable. This is another ratepayer/taxpayer expenses that is not needed.

4 April 2024

Mayor
Whakatane District Council
Commerce St
Whakatane.

Re: Submission and Object to Shaw Road – Mill Road roundabout connection (Whakatane District Council Longer Term Plan 2023-34 page 18)

We are aware that on the discussion table is the moving of the **Shaw Road entrance to Mill Road**, as stated in 'The Solution: Suggestion 3' of the recent submission submitted by many new residence of the Shaw Road new development.

We, the house-hold of [REDACTED], have voiced our views to many and given our reasons for not supporting this including Waka Kotahi, and Whakatane District Council, and we believe that if you were us, we believe you would not like the idea too and will support our viewpoint.

We would like to provide you with a little history about us and 30 Shaw Road past owners, **as this discussion is not new.**

We have been living at [REDACTED] for over 25 years, we purchased the property off Kevin and Linda Forbes who lived at [REDACTED] for many years too. They advised us at the time of purchase that a proposal to do exactly the same was put to them and the then Shaw Road residents (which was much less), they opposed, for similar reasons the we are opposing, and it did not go ahead, that being:

- 1 The traffic will seriously impact our property (immensely) and will be dangerous for our house-hold due to speeding and high volume of vehicles
- 2 Traffic noise nuisance (all day and night)

Additional concerns for our close neighbours:

- 3 The traffic will seriously impact several other properties on Shaw Road
- 4 The traffic will be dangerous for their house-hold, and
- 5 Traffic noise nuisance will be an issue to.

Our property (Red and Tui Edward) is home for us and our extended family for over 25 years. We have currently living with us our two daughters and their partners, four grandchildren and at times their grandfather (Red's father), 2 dogs and 2 cats. That is 11 people (four generations), 4 under the age of 8 years (1 new born), and 1 over 82 years.

- Back when the Forbes owned the property (approx. 26 years ago), the road was very busy but only during summer when Julian's Berry Farm operated at the end of Shaw Road.
- Today, due to the Shaw Road subdivision there are many more homes, there are 60 homes new homes which will increase, and this has increased the traffic volume considerably. At the moment approximately 79 homes use the intersection. We supported Barney and Prue Gray to develop the Shaw subdivision as there is a need for housing development, but we would not support to move the Shaw Road entrance to where it is suggested.
- If the entrance to Shaw Road is to change that will be many cars/vehicles driving pass our home morning and night. We estimate each house will have a minimum of 2 cars and times that by 79. That is 158 vehicles morning and night.

We have seen many accidents on Shaw Road over the years, mainly due to speeding and underestimating the turn by our property. Just before Christmas 2022 someone skidded around the corner and smashed up their car and our fence. It costed over \$2000 to repair the fence, and we had to spend many hours cleaning up the mess. This is the third person to hit our fence. We have seen people drive straight into the Kopeopeo canal, motorbikes and cars. Most of these people are visiting people down the road and do not seem to care about the safety of people living along the road, and will speed as the road is nice and long and straight. We expect the same inconsiderate driving attitude will continue in the future regardless of any changes made, and are fearful if the Shaw Road entrance is to change, we believe incidences will increase, as the road will be longer.

Proposal:

1. The current Shaw Road entrance remains and made safer by widening the turn in and out or a look at building a roundabout
2. Reduce the speed down on Highway (reduce to at least 60 km ph)
3. Speed humps along Shaw Road to slow Shaw Road traffic
4. Better use of rate/taxpayers funds: to build what is proposed is wasted ratepayers money what is needed is a new entrance to Shaw Road. Better use of funds to be used on urgent roading projects that will benefit the whole of the community, like **building another bridge into Whakatane.**

Also, we have concerns regarding another subdivision which is proposed to be built next to the Shaw Road subdivision, careful planning needs to done on how this subdivisions traffic will be managed and how it will impact our property, as we believe it is proposed that the roads will link to Shaw Road, that will be even more traffic flow.

We ask for your consideration on the impact this project will have on our whanau and neighbouring whanau on Shaw Road.

Naku noa



Tui and Red Edwards whanau

Submission ID: 302

Date: Apr 04 24 03:43:14 pm

Name:

David Goodall

Organisation (if on behalf of organisation)

How should we scale, fund and stage necessary upgrades to the Rex Morpeth Recreation Hub?

Your thoughts on how should we scale, fund and stage necessary upgrades to the Rex Morpeth Recreation Hub:

I am against any of these 3 options at this time, as the level of debt incurred on the ratepayers is just too much. I am also astounded that Option 4 was left off the submission form. I understand that this option had the most support by the respondents, and should not have been removed. To me, that is the most prudent scenario in these current financial times. Even this option should only be limited to Maintenance needs in the interests of safety and practicality of use. The seismic strengthening of the Rugby park grandstand has been accepted as meeting the basic levels of safety, and, in light of the possibility of future demolition, I think that apart from basic maintenance, it should be left at the status quo. I do not understand the need for another 100 carparks, or the need to upgrade the existing playground either. To my mind, these are the "Nice to Have", not the Need to Have!

How should we manage foodwaste collection?

Option 1: Mixed foodwaste and greenwaste for urban properties only.

Your thoughts on how we should manage foodwaste collection:

How quickly should we close our funding gap?

Option 3: Close the gap in the medium-term (in six years) to ease the burden now.

Your thoughts on closing our funding gap:

How should we distribute rates increases across the properties in our district?

Option 3: 16% UAGC – \$559.13 (GST exclusive) in year 1.

Your thoughts on how we should distribute rates increases across the properties in our district:

Supporting document

N/A

Do you have any other feedback for your Mayor and Councillors?

In general, I am against The Council spending money on things that are not absolutely essential. I do not think that a single dollar more of ratepayer money should be spent on the "Boat Harbour." To me that project is a private enterprise, and if they wish to pour money into a bottomless pit, (Decontamination, etc,) let it be on their heads. I also strongly believe that the subject of a second bridge should be included in the current Long Term Plan. As we all know "these things take time," but I think that it is imperative that we make a start now. With the current Government throwing the 3 Waters back to councils, if we are to borrow extra funds, it should be utilised for these essentials. In summary, the Council cannot afford these nice to have extra costs at the moment, any more than the Ratepayers or the Residents. It is time to be fiscally responsible, and "Cut or Coat to suit our Cloth.

Name:

Organisation (if on behalf of organisation)

How should we scale, fund and stage necessary upgrades to the Rex Morpeth Recreation Hub?

Your thoughts on how should we scale, fund and stage necessary upgrades to the Rex Morpeth Recreation Hub:

How should we manage foodwaste collection?

Your thoughts on how we should manage foodwaste collection:

How quickly should we close our funding gap?

Your thoughts on closing our funding gap:

How should we distribute rates increases across the properties in our district?

Your thoughts on how we should distribute rates increases across the properties in our district:

Supporting document

N/A

Do you have any other feedback for your Mayor and Councillors?

I object to the proposal that Murupara residents pay a fee to use our transfer station. Having our free dump is probably one of the only advantages we get, we don't get all the beautification and facilities that Whakatane gets, yet we still pay high rates every year. If people from outside the district are using the dump then how about a sticker for residents vehicles so staff can see who's dumping the rubbish and if they're from here or not. And as for the fact sheet saying basically it doesn't matter if there's an increase in illegal dumping because people are already doing it, what a cop out. There's people in our community that go out at their own time and expense to those illegal dump sites in the forest and by the rivers etc, remove the rubbish and take it to the dump. Do you want to charge them too for their efforts? hardly an incentive for people to keep the community clean if it's going to cost them big money everytime to take rubbish to the dump.

Submission ID: 304

Date: Apr 04 24 09:27:25 pm

Name:

Michelle Dodson

Organisation (if on behalf of organisation)

How should we scale, fund and stage necessary upgrades to the Rex Morpeth Recreation Hub?

Your thoughts on how should we scale, fund and stage necessary upgrades to the Rex Morpeth Recreation Hub:

Only necessary maintenance bare minimum to keep costs down tighten your belts people are struggling get real !!

How should we manage foodwaste collection?

Your thoughts on how we should manage foodwaste collection:

Why are you even doing this

How quickly should we close our funding gap?

Your thoughts on closing our funding gap:

People are struggling it is not our fault you are in debt get your debt sorted before you spend more

How should we distribute rates increases across the properties in our district?

Your thoughts on how we should distribute rates increases across the properties in our district:

Dont increase people are struggling they will lose their homes

Supporting document

N/A

Do you have any other feedback for your Mayor and Councillors?

Name:

Organisation (if on behalf of organisation)

How should we scale, fund and stage necessary upgrades to the Rex Morpeth Recreation Hub?

Your thoughts on how should we scale, fund and stage necessary upgrades to the Rex Morpeth Recreation Hub:

Necessary maintenance to existing structure.

How should we manage foodwaste collection?

Option 1: Mixed foodwaste and greenwaste for urban properties only.

Your thoughts on how we should manage foodwaste collection:

Invest in composting for residents so they can do there own.

How quickly should we close our funding gap?

Option 3: Close the gap in the medium-term (in six years) to ease the burden now.

Your thoughts on closing our funding gap:

Stop development of new community projects. Only maintain current infrastructure.

How should we distribute rates increases across the properties in our district?

Option 3: 16% UAGC – \$559.13 (GST exclusive) in year 1.

Your thoughts on how we should distribute rates increases across the properties in our district:

Supporting document

N/A

Do you have any other feedback for your Mayor and Councillors?

Submission ID: 306

Date: Apr 04 24 09:31:01 pm

Name:

Lyndell Jones

Organisation (if on behalf of organisation)

How should we scale, fund and stage necessary upgrades to the Rex Morpeth Recreation Hub?

Your thoughts on how should we scale, fund and stage necessary upgrades to the Rex Morpeth Recreation Hub:

Only necessary maintenance should be undertaken, no improvements! only maintenance! Tighten your belts on our behalf! People WILL lose their homes with rates increases. This is not good enough!

How should we manage foodwaste collection?

Your thoughts on how we should manage foodwaste collection:

Don't change it

How quickly should we close our funding gap?

Option 3: Close the gap in the medium-term (in six years) to ease the burden now.

Your thoughts on closing our funding gap:

Option 3 - and stop spending money on unnecessary things for the next few years. This is our money and you need to stop building your own trophies.

How should we distribute rates increases across the properties in our district?

Your thoughts on how we should distribute rates increases across the properties in our district:

Stop the rates increases!

Supporting document

N/A

Do you have any other feedback for your Mayor and Councillors?

Feeling a bit gutted actually! This is a beautiful town but it is currently being run by a very top heavy council with grandiose plans and what feels like little town thought about the residents.

Name:

Organisation (if on behalf of organisation)

How should we scale, fund and stage necessary upgrades to the Rex Morpeth Recreation Hub?

Option 3: Carry out necessary upgrades to the Rex Morpeth Recreation Hub

Your thoughts on how should we scale, fund and stage necessary upgrades to the Rex Morpeth Recreation Hub:

How should we manage foodwaste collection?

Option 1: Mixed foodwaste and greenwaste for urban properties only.

Your thoughts on how we should manage foodwaste collection:

How quickly should we close our funding gap?

Option 3: Close the gap in the medium-term (in six years) to ease the burden now.

Your thoughts on closing our funding gap:

How should we distribute rates increases across the properties in our district?

Option 3: 16% UAGC – \$559.13 (GST exclusive) in year 1.

Your thoughts on how we should distribute rates increases across the properties in our district:

Supporting document

N/A

Do you have any other feedback for your Mayor and Councillors?

Name:**Organisation (if on behalf of organisation)****How should we scale, fund and stage necessary upgrades to the Rex Morpeth Recreation Hub?**

Option 3: Carry out necessary upgrades to the Rex Morpeth Recreation Hub

Your thoughts on how should we scale, fund and stage necessary upgrades to the Rex Morpeth Recreation Hub:

It is not the time to invest in 'nice to have' changes in rex morpeth park - money should be spent on essential needs only. Costs of living are too high and we need to minimise expenses to the community. Development contributions are not appropriate source of funding, as this will ultimately increase the costs of new development/housing - which is not appropriate given the current housing crisis. Development contributions should only be for infrastructure growth associated with that particular development

How should we manage foodwaste collection?

Option 1: Mixed foodwaste and greenwaste for urban properties only.

Your thoughts on how we should manage foodwaste collection:

Fortnightly general waste collection requires that households get bigger general waste bins. Tauranga City Council made this change (and did not increase bin size) and this led to significant increase in illegal dumping. Note that most rural properties already have compost and/or worm farms - so make this an opt-in option for rural properties, this will avoid wasting money and compost bins/worm farms. It is important that - if option 1 or 2 is selected - that these costs are not passed onto rural ratepayers. They already pay huge rates for very little services/benefits.

How quickly should we close our funding gap?

Option 3: Close the gap in the medium-term (in six years) to ease the burden now.

Your thoughts on closing our funding gap:

Close the gap by not creating such a big gap in the first place...Council is spending too much on 'nice to haves' and not focusing solely on bare essentials during this time of high costs of living. If you really cared about the wellbeing of the communities, then you wouldn't be wasting their money on nice to haves during this time. Once the economy has recovered, then we can spend more on 'nice to haves'.

How should we distribute rates increases across the properties in our district?

Option 3: 16% UAGC – \$559.13 (GST exclusive) in year 1.

Your thoughts on how we should distribute rates increases across the properties in our district:

More emphasis on targeted rates, so that those benefitting are paying for it.

Supporting document

N/A

Do you have any other feedback for your Mayor and Councillors?

You are spending too much on 'nice to haves', we need to focus solely on essential costs during this time whereby the costs of living are too high. It is not the time to be spending on nice to haves (such as unnecessary rex morpeth park upgrades). Essential costs are roading, 3 waters, climate change, and housing. The public would appreciate it more if you did less.

Name:**Organisation (if on behalf of organisation)** My household (3)**How should we scale, fund and stage necessary upgrades to the Rex Morpeth Recreation Hub?**

Option 3: Carry out necessary upgrades to the Rex Morpeth Recreation Hub

Your thoughts on how should we scale, fund and stage necessary upgrades to the Rex Morpeth Recreation Hub:

Please note the population decline (the elderly population is still growing, but not youth). It is a worldwide fact that fewer people are choosing to have families, the population of the young is declining and there is no data that this trend will change in the next 50 years. Therefore tax payers as a group will start (or has started) to decrease. Only carry out what is necessary maintenance. I use the War Memorial basketball court weekly and it leaks, this is a hazard. Fix the leak. The little theatre also has leaks, near electrical equipment, also a hazard. Fix the hazards. But gutting whole portions of buildings, creating waste when the majority of it was still usable is a crime against the planet. And once something is imported, it doesn't leave this island.

How should we manage foodwaste collection?

Option 1: Mixed foodwaste and greenwaste for urban properties only.

Your thoughts on how we should manage foodwaste collection:

Please also include places around the rohi to drop off pure foodwaste for rural and urban and restaurants and travelers. I suspect this will be used en masse, especially during the school year as more children reject the school lunches.

How quickly should we close our funding gap?

Option 1: Close the gap quickly (in one year) so we pay less in the future.

Your thoughts on closing our funding gap:

I cannot stress enough that the young population is shrinking, there will not be growth in the tax payer base, only an increase in monetary spending requirements for the elderly. It's not fair to push all this debt onto young people, the new tax payers who will only be paying off debt instead of enjoying seeing their taxes make a benefit to their lives (clean water, roads, sewers, climate change, transportation).

How should we distribute rates increases across the properties in our district?

Option 1: (Status quo) – 24% UAGC – \$927.50 (GST exclusive) in year 1.

Your thoughts on how we should distribute rates increases across the properties in our district:

Churches should also be paying. Expand the allowance for tiny homes in the district and add them to the rate payer base.

Supporting document

N/A

Do you have any other feedback for your Mayor and Councillors?

The tax payer base is shrinking, look at the world population trends. No new boat harbour! We need a second bridge. Fund emergency and low income housing. Streamline tiny homes, and use this as a new source of rates and a solution to the housing problem. Close Ohope Beach School, it's cheaper to bus them to town and would increase funding at the other schools and make Pohutukawa safer. No new car parks (more car parks is not a solution to climate change). Maintain Rex Morpeth, don't knock it out and

create a bunch of waste and import more rubbish that will also just get knocked out in the future. Why are there so many district councillors? Surely we only need half as many. Make changes in the budgeting that would allow for the cancellation of unnecessary expenditure (from past bad decisions) to get put back into the current expenditure on the necessary. Churches should pay rates and GST and liquor licensing and ACC and EAP and all the other taxes and fees of normal organisations. Don't make deals with capitalists, they'll privatise the profits and socialise costs. Don't believe their promises. Maintain the wharf, don't "upgrade." Fix/upgrade the water and sewer systems. Fluoride is an advancement in science that we should benefit from. Upgrade earthquake and disaster infrastructure. Approve the building projects at the hospital faster. Keep the investments we already have in the portfolio (rainier days are coming). We don't need more wedding venues or drinking establishments. Cancelling "spendy" projects is imperative, we shouldn't be worried about hurting feelings when trimming fat we can't afford. Don't push debt onto a future smaller population of tax payers who never benefited from this rubbish.

Name:**Organisation (if on behalf of organisation)****How should we scale, fund and stage necessary upgrades to the Rex Morpeth Recreation Hub?**

Option 3: Carry out necessary upgrades to the Rex Morpeth Recreation Hub

Your thoughts on how should we scale, fund and stage necessary upgrades to the Rex Morpeth Recreation Hub:

ONLY do the MINIMUM necessary to keep the Rex Morpeth Recreation Hub safe to operate and use. Whilst improvements are needed, the situation is NOT so dire that it cannot wait until New Zealand's, and Whakatane's economy recovers. Cost of borrowing will come down and rate-payers will have more money available to spend on rates.

How should we manage foodwaste collection?**Your thoughts on how we should manage foodwaste collection:**

Why should ALL rate-payers pay for those who choose to waste food? This should NOT be funded by Council. By all means, use existing, in-house experts to advise community members on how they can manage their OWN food waste (e.g., how to make a compost bin, etc.). Advisers could, say, attend the Ohope and Whakatane markets (combining with Envirohub?) to demonstrate these activities. This may also provide a springboard for local entrepreneurs to support food waste management practices.

How quickly should we close our funding gap?

Option 3: Close the gap in the medium-term (in six years) to ease the burden now.

Your thoughts on closing our funding gap:

Times are VERY hard for EVERYONE right now. Whilst IN PRINCIPLE I can see merit in paying more in the short term, any gains are MORE than offset by the potentially catastrophic effect huge rates increases will have on ordinary households. If this Council CARES (which, in my experience, is a sadly debateable point), they will NOT make large rates increases for the next three years AT LEAST to allow the economy to recover. It is NOT acceptable to use rate-payers as a means to gaining 'loans' against the potential for mortgagee sales to pay rate arrears. CARING Councils DO NOT DO THAT!

How should we distribute rates increases across the properties in our district?

Option 3: 16% UAGC – \$559.13 (GST exclusive) in year 1.

Your thoughts on how we should distribute rates increases across the properties in our district:

For goodness sake - those in lower-value properties are often those least able to afford rates increases. Help them out at this very difficult time!

Supporting document

N/A

Do you have any other feedback for your Mayor and Councillors?

The CE needs to stop 'empire-building'. When she was first appointed I thought Steph might be good for the District. I no longer believe that. I have lost confidence in her, and her Council, to think beyond themselves and feathering their own nests for the future. I am also unimpressed with Mayor Dr Luca. He is undoubtedly highly intelligent but his ego is huge and his attitude towards people needs improving. STOP TALKING 'DOWN' to people, Victor!

Submission ID: 311

Date: Apr 05 24 11:33:54 am

Name:

Miro Araroa Chairman RHC

Organisation (if on behalf of organisation)

Rangitaiki River Forum Ngati Awa

How should we scale, fund and stage necessary upgrades to the Rex Morpeth Recreation Hub?

Your thoughts on how should we scale, fund and stage necessary upgrades to the Rex Morpeth Recreation Hub:

Cosmetic repairs

How should we manage foodwaste collection?

Option 2: Separate foodwaste collection for urban properties only.

Your thoughts on how we should manage foodwaste collection:

Lease more land

How quickly should we close our funding gap?

Option 3: Close the gap in the medium-term (in six years) to ease the burden now.

Your thoughts on closing our funding gap:

Costs of living too high

How should we distribute rates increases across the properties in our district?

Option 3: 16% UAGC – \$559.13 (GST exclusive) in year 1.

Your thoughts on how we should distribute rates increases across the properties in our district:

Costs of living too high

Supporting document

N/A

Do you have any other feedback for your Mayor and Councillors?

Yes could you look at reinstating the camp ground back to traditional ownership in RHC, Ngati Awa also we would like to bring back the shared cost of running the district council and regional council heaps of savings the regional council should be generous as their income from local rate payers is used alot on investments and wasteful spending

Submission ID: 312

Date: Apr 05 24 12:04:43 pm

Name:

Paul Camburn

Organisation (if on behalf of organisation)

How should we scale, fund and stage necessary upgrades to the Rex Morpeth Recreation Hub?

Option 1: Carry out redevelopment of the Rex Morpeth Recreation Hub as soon as possible. This requires us to secure 35% external funding for major development works in 2028 and 2029.

Your thoughts on how should we scale, fund and stage necessary upgrades to the Rex Morpeth Recreation Hub:

Try to keep interruptions to sports as minimal as possible, get the works done as much as possible in off season when possible.

How should we manage foodwaste collection?

Option 1: Mixed foodwaste and greenwaste for urban properties only.

Your thoughts on how we should manage foodwaste collection:

Add it into the greenwaste as it can all be composted and reused. No meat products to be added.

How quickly should we close our funding gap?

Option 1: Close the gap quickly (in one year) so we pay less in the future.

Your thoughts on closing our funding gap:

How should we distribute rates increases across the properties in our district?

Option 3: 16% UAGC – \$559.13 (GST exclusive) in year 1.

Your thoughts on how we should distribute rates increases across the properties in our district:

Supporting document

N/A

Do you have any other feedback for your Mayor and Councillors?

People need to look to the future generations and future proof for them and their needs as well as ours.

Name:

Organisation (if on behalf of organisation)

How should we scale, fund and stage necessary upgrades to the Rex Morpeth Recreation Hub?

Your thoughts on how should we scale, fund and stage necessary upgrades to the Rex Morpeth Recreation Hub:

These projects need to wait! Yes upgrades need to be made but taking many many families who are already struggling below the poverty line is unacceptable! Recreation is important but not vital

How should we manage foodwaste collection?

Your thoughts on how we should manage foodwaste collection:

Keep as is. Why fix something that's not broken

How quickly should we close our funding gap?

Your thoughts on closing our funding gap:

How should we distribute rates increases across the properties in our district?

Your thoughts on how we should distribute rates increases across the properties in our district:

All increases are totally unacceptable!!!!!! Stop spending OUR money on your stupid projects. IT IS NOT YOUR MONEY!!! You ALL were selected by the public, you work for them. Cut your pay increases, stop driving round in your new vehicles, make do, like we have to, stop employing large amounts of staff on huge salaries and make do, like all the local businesses are forced to do due to hardship.

Supporting document

N/A

Do you have any other feedback for your Mayor and Councillors?

I will think very carefully about my votes next time when elections happen! I will NOT be voting for ANY of the current Councillors or Mayor. I think most of Whakatane will be thinking the same this time!

Submission ID: 314

Date: Apr 05 24 01:06:20 pm

Name:

Mark Pilcher

Organisation (if on behalf of organisation)

How should we scale, fund and stage necessary upgrades to the Rex Morpeth Recreation Hub?

Option 3: Carry out necessary upgrades to the Rex Morpeth Recreation Hub

Your thoughts on how should we scale, fund and stage necessary upgrades to the Rex Morpeth Recreation Hub:

Carry out absolutely essential repairs only

How should we manage foodwaste collection?

Option 1: Mixed foodwaste and greenwaste for urban properties only.

Your thoughts on how we should manage foodwaste collection:

Keep costs to a minimum and encourage individual responsibility to recycle food waste. ie composts & worm farms

How quickly should we close our funding gap?

Option 3: Close the gap in the medium-term (in six years) to ease the burden now.

Your thoughts on closing our funding gap:

Ideally we should close gap ASAP, but I know of too many people who are struggling with the current rates and cost of living. A rates increase of >10% would be just too much for most people to afford

How should we distribute rates increases across the properties in our district?

Option 3: 16% UAGC – \$559.13 (GST exclusive) in year 1.

Your thoughts on how we should distribute rates increases across the properties in our district:

These increases are staggering! I cannot believe the council have allowed this to happen

Supporting document

N/A

Do you have any other feedback for your Mayor and Councillors?

Councilors who campaigned to keep rates affordable, should be doing more. The meek acceptance of such outrageous increases in rates is not good enough. Tough times mean tough decisions. Time to face the current reality & postpone or cancel non essential projects & spending. Come the next local body election we will remember

Name:

Organisation (if on behalf of organisation)

How should we scale, fund and stage necessary upgrades to the Rex Morpeth Recreation Hub?

Option 2: Carry out redevelopment of the Rex Morpeth Recreation Hub as soon as possible. This requires us to secure 50% external funding for major development works in 2029 and 2030.

Your thoughts on how should we scale, fund and stage necessary upgrades to the Rex Morpeth Recreation Hub:

How should we manage foodwaste collection?

Option 1: Mixed foodwaste and greenwaste for urban properties only.

Your thoughts on how we should manage foodwaste collection:

I don't think that even option 1 is necessary. Most households in have gardens. We received a free compost bin from the council 5 years ago and use this for food waste. Only meat ends up in the waste bin and will end up in there as is can't be put in the green waste bin. Supply compost bins or worm farms for all residents.

How quickly should we close our funding gap?

Option 3: Close the gap in the medium-term (in six years) to ease the burden now.

Your thoughts on closing our funding gap:

How should we distribute rates increases across the properties in our district?

Option 3: 16% UAGC – \$559.13 (GST exclusive) in year 1.

Your thoughts on how we should distribute rates increases across the properties in our district:

We also need to consider other costs rising, in particular insurance, internet, phone, fees for sports and petrol.

Supporting document

N/A

Do you have any other feedback for your Mayor and Councillors?

Submission ID: 316

Date: Apr 05 24 01:50:28 pm

Name:

John Stothers

Organisation (if on behalf of organisation)

How should we scale, fund and stage necessary upgrades to the Rex Morpeth Recreation Hub?

Your thoughts on how should we scale, fund and stage necessary upgrades to the Rex Morpeth Recreation Hub:

To be put on hold for at least 4 years. NO MONEY to be spent other than absolutely necessary maintenance, and then reviewed. NZ Government is reducing costs and services in response to the present economic conditions, as such, WDC should be doing the same.

How should we manage foodwaste collection?

Your thoughts on how we should manage foodwaste collection:

Do nothing. Foodwaste is not worth the hassle or funds when there are greater issues.

How quickly should we close our funding gap?

Option 3: Close the gap in the medium-term (in six years) to ease the burden now.

Your thoughts on closing our funding gap:

In 6 years or longer. Again, not the economic conditions for borrowing money, or for extravagant money expenditure.

How should we distribute rates increases across the properties in our district?

Your thoughts on how we should distribute rates increases across the properties in our district:

AGAINST ANY RATE INCREASE THAT IS GREATER THAN THE INFLATION INDEX. Rate increases to match the index.

Supporting document

Attached

Do you have any other feedback for your Mayor and Councillors?

PLANNING FOR THE FUTURE GROWTH OF THE WHAKATANE DISTRICT

The need for a second bridge at Whakatane

On the map on PAGE 2, the BLUE LINE represents a possible future line for a road connecting to a secondary bridge. The bridge would be in the vicinity of Titoki Road, crossing the river towards the Taneatua/Whakatane Road, near the Blue Rock Quarry, and connecting to Wainui Road near McCoy Road.

Reason: Traffic congestion in Whakatane is increasing bringing ongoing issues. A traffic study commissioned by the Whakatane District Council in 2006 and presented in July 2008, predicted ongoing traffic issues with a single bridge in Whakatane. The traffic study prediction is accurate to where Whakatane is presently, with future forecast from this study a serious concern.

A second bridge and alternate route would alleviate or enable the following;

- A. Traffic congestion would lessen
- B. Provides security with an alternate route when faced with flooding/tsunami
- C. Would allow through traffic (ie: Opotiki to Tauranga) quicker access and be able to bypass Whakatane township, as through traffic has already bypassed Te Puke with the toll road.
- D. Ohope would gain a secondary access route to Whakatane
- E. Would open the Wainui area up for future housing and/or industrial growth.
- F. Currently 90% of traffic travels through Whakatane, and 10% Pikotahi Bridge. Travelling from Opotiki to Tauranga is presently 17kms shorter through Whakatane than via Taneatua route, thus many people chose the shorter route through Whakatane township. Google maps provides shorter route options as a first choice for travellers, which adds pressure.
- G. With the Opotiki mussel farm development and forestry industry increasing, a good future road is required for industrial growth in the area for future proofing.
- H. A decent second bridge would provide a valuable asset for future generations.

I wish to speak/formally present to each of these points in person.

John Stothers





HORIZONTAL DATUM: New Zealand Geodetic Datum 2000 For practical purposes, NZGD2000 equates to WGS84 VERTICAL DATUM: Mean Sea Level PROJECTION: New Zealand Transverse Mercator 2000 © Bay of Plenty Regional Council, 2013 © Sourced from: Land Information New Zealand data. CROWN COPYRIGHT RESERVED

Bay of Plenty Regional Council Map

Projection: NZGD_2000_New_Zealand_Transverse_Mercator

SCALE 1:36,112

Date Printed:
4 March 2024

Submission ID: 317

Date: Apr 05 24 02:28:59 pm

Name:

Mawera Karetai

Organisation (if on behalf of organisation) Whakatane High School Mountain bike team

How should we scale, fund and stage necessary upgrades to the Rex Morpeth Recreation Hub?

Your thoughts on how should we scale, fund and stage necessary upgrades to the Rex Morpeth Recreation Hub:

How should we manage foodwaste collection?

Your thoughts on how we should manage foodwaste collection:

How quickly should we close our funding gap?

Your thoughts on closing our funding gap:

How should we distribute rates increases across the properties in our district?

Your thoughts on how we should distribute rates increases across the properties in our district:

Supporting document

N/A

Do you have any other feedback for your Mayor and Councillors?

For a long time now we have been asking Council to help create appropriate spaces for mountain biking in the community. Currently all the available local spaces that would be suitable are used by walkers who won't share. As we have seen at Onepu MTB park, mountain bikers are willing to share with walkers, and everyone can happily exist together. Currently our kids have to be driven to Onepu, and Rotorua for good training trails and from an environmental perspective, this is actually not ok. I am here asking AGAIN that the Council please actively support the development of a mountain bike trail network that we can use, without walkers being able to stop the kids riding. I promise you we won't stop them walking.

Submission ID: 318

Date: Apr 05 24 02:57:52 pm

Name:

Catrina Jones

Organisation (if on behalf of organisation)

How should we scale, fund and stage necessary upgrades to the Rex Morpeth Recreation Hub?

Your thoughts on how should we scale, fund and stage necessary upgrades to the Rex Morpeth Recreation Hub:

My option. Do maintenance work only. The War Memorial Hall will not close down. Earthquake strengthened in 2020. Grandstand can be strengthened at small cost. We can get by-as is. . Facilities can be adequate for 5-10 years more

How should we manage foodwaste collection?

Option 1: Mixed foodwaste and greenwaste for urban properties only.

Your thoughts on how we should manage foodwaste collection:

How quickly should we close our funding gap?

Option 2: Close the gap in the short-term (in three years) to avoid greater debt.

Your thoughts on closing our funding gap:

WDC should think wisely about what projects are a priority and cut down on borrowing/spending on non essential jobs. Infrastructure is important. RMH is not infrastructure. Applying for a AA+ rating is well and good .bur low %rate borrowing is still a debt. . WDC Personnel salaries/wages for 2023 exceeded its budget by \$2.4m. 2018=\$18M, 2023=\$25.2M . Salaries need to be reviewed/controlled. No new jobs.

How should we distribute rates increases across the properties in our district?

Your thoughts on how we should distribute rates increases across the properties in our district:

My option is 7.95% increase . The above 3 options gst exclusive are far too high. I appreciate sincerely the commitment, ,dedication, time and effort every councillor gives. You are thinking of future generations. I hear/know/witness struggling young families now- increased mortgage,food etc. ..Pensioners struggle too. I am aggrieved at the deception and unwarranted overspend on Civic Centre. We could have addressed H&Safety within \$880k. \$13M could have been saved. It was a functioning EOC prior to upgrade but is still in the blue line on evacuation list if tsunami warning . Not ideal place for flooding either. , Tidal pool has been a costly failure. Harbour project should not be considered. No one should invest in a project on contaminated land-. It is unthinkable to be in partnership with such an arrangement (further costs) . Harbour/marina is a luxury. I am dubious about all the advantages and roll on effects if completed that is professed to bring to Whakatane. I think the money spent on reports and outsourcing to consultancies should be reviewed and kept in check. I Council should prioritise infrastructure needs. Time and effort should be on a 2nd crossing. Regional Council have budgeted \$500k for a business case for a 2nd crossing. When economy improves the wants can be introduced.

Supporting document

N/A

Do you have any other feedback for your Mayor and Councillors?

I realise since Covid locally, nationally and globally people have experienced economic difficulties never

imagined. Councillors should treat WDC as their own business. When business gets tough you take measures to reduce loss. You should not take risks- do not keep spending/borrowing . I feel that some decisions have been unwise/unecessary /unwarranted We are all entitled to our opinions. We all see things from different perspectives. I appreciate everyone's views. I I

Name:

Organisation (if on behalf of organisation)

How should we scale, fund and stage necessary upgrades to the Rex Morpeth Recreation Hub?

Option 2: Carry out redevelopment of the Rex Morpeth Recreation Hub as soon as possible. This requires us to secure 50% external funding for major development works in 2029 and 2030.

Your thoughts on how should we scale, fund and stage necessary upgrades to the Rex Morpeth Recreation Hub:

My feeling is that we need to do rather more than just the bare minimum. The Memorial Hall is our major Civil Defence centre and needs to be upgraded to the highest possible standard. Building and labour costs are unlikely to decrease anytime soon, if ever, so it will never be cheaper to do this than it is now. The grandstand needs earthquake strengthening but possibly can be left for redevelopment in the future once this is done. More carparking is certainly needed.

How should we manage foodwaste collection?

Option 1: Mixed foodwaste and greenwaste for urban properties only.

Your thoughts on how we should manage foodwaste collection:

We currently compost all our food waste that is suitable. We realise that not every-one wants to, or is able to do this, but since it will eventually be mixed with the rest of the green waste why collect it separately in the first place.

How quickly should we close our funding gap?

Option 3: Close the gap in the medium-term (in six years) to ease the burden now.

Your thoughts on closing our funding gap:

I am optimistic enough to believe that the financial situation in six years time will be better than it is currently. In the meantime those of us on fixed incomes will have a drop in our standard of living if faced with a major increase in rates. I accept that an increase is necessary but I would rather it was spread out across several years.

How should we distribute rates increases across the properties in our district?

Option 2: 20% UAGC – \$741.31 (GST exclusive) in year 1.

Your thoughts on how we should distribute rates increases across the properties in our district:

Supporting document

N/A

Do you have any other feedback for your Mayor and Councillors?

Please reopen the library and museum on Sundays. The savings from this closure must be miniscule since the staff are all on contracted hours and will just have been rescheduled during the week. Feedback from visitors to town tells me they are very disappointed not to be able to see the Museum/ Gallery during their visit, especially when we have exhibitions of national interest like Molly Morpeth.

Name:

Organisation (if on behalf of organisation)

How should we scale, fund and stage necessary upgrades to the Rex Morpeth Recreation Hub?

Your thoughts on how should we scale, fund and stage necessary upgrades to the Rex Morpeth Recreation Hub:

Is the upgrade necessary? We were lied to, about the supposed Earthquake strengthening on the Council offices to the tune of \$13 million. IF the War Memorial Hall needs GENUINE remedial work then that work should be carried out. General upgrade of kitchen, toilet, sports area and Little theatre should be based on current usage and im sure some of these could be carried out at low cost perhaps by funding the upgrade through naming rights. Westpac Little theater?

How should we manage foodwaste collection?

Option 1: Mixed foodwaste and greenwaste for urban properties only.

Your thoughts on how we should manage foodwaste collection:

If food waste is mixed in with food waste why is a raise in rates of \$35-\$45 necessary as you would be using existing equipment?

How quickly should we close our funding gap?

Option 3: Close the gap in the medium-term (in six years) to ease the burden now.

Your thoughts on closing our funding gap:

Pensioners, especially, are hurting now. Rents, food, petrol, rates, (both Regional and District Councils) power, insurances and medical costs are all increasing yearly (and in some cases like petrol and food weekly) whilst the pension has not and hasnt in the last 12 years. Any increases need to be minimal, preferably single digit,

How should we distribute rates increases across the properties in our district?

Your thoughts on how we should distribute rates increases across the properties in our district:

Single digit.

Supporting document

N/A

Do you have any other feedback for your Mayor and Councillors?

It is concerning that the council refused to disclose how many staff are receiving over \$100K salaries. That tells me that there are quite a few and the council is not willing to share this information. Perhaps each one of those individuals should have their salaries decreased by 24%, 20% or 16%. So far the council has ignored public opinion in its consultation (Kiddies pool at the heads) despite expert data showing it was not feasible. Lied to about the need for Earthquake strengthening of council office and manipulated data(350 signatures for a second bridge counted as 1) In my opinion, certain councillors have lost all credibility and need to be reined in on their ignorance of the rape and pillage of the bank of rate payers. As highlighted by Wellingtons water disgrace and Aucklands sewerage problems, councils need to adhere to their regions basic needs NOT grandiose vanity projects.

Name:

Organisation (if on behalf of organisation)

How should we scale, fund and stage necessary upgrades to the Rex Morpeth Recreation Hub?

Option 3: Carry out necessary upgrades to the Rex Morpeth Recreation Hub

Your thoughts on how should we scale, fund and stage necessary upgrades to the Rex Morpeth Recreation Hub:

How should we manage foodwaste collection?

Option 2: Separate foodwaste collection for urban properties only.

Your thoughts on how we should manage foodwaste collection:

How quickly should we close our funding gap?

Option 2: Close the gap in the short-term (in three years) to avoid greater debt.

Your thoughts on closing our funding gap:

Many are struggling, but the can has been kicked down the road for too long by councils focussed on nice-to-haves but ignoring necessary infrastructure needed, and not willing or unable to bring the community along. We must address necessary work in 3 waters infrastructure, in climate resilience, in energy-efficient transportation and accessibility projects.

How should we distribute rates increases across the properties in our district?

Option 2: 20% UAGC – \$741.31 (GST exclusive) in year 1.

Your thoughts on how we should distribute rates increases across the properties in our district:

Those who benefit the most should pay the most. Property used for business- whether urban or rural - should pay more.

Supporting document

N/A

Do you have any other feedback for your Mayor and Councillors?

I'm disappointed that a council who loudly opposed the previous Government's plan for 3 waters resilience is now stating 'oh we can't fix our infrastructure because it's too costly now that 3 waters has been canned'.. & have now taken a back seat approach.. 'we don't have the \$ so...' Whakatāne district has suffered from issues with flooding, stormwater inundation, fresh water delivery, etc for many decades! With successive councillors running on "I won't put your rates up". Such short-sightedness needs to stop. Make a proper plan. What needs to be done to fix it. How much will it cost. Actively & loudly campaign the government for support. Explore all options. Rate rises specifically targeted to address. Bring the community along with some hard-hitting PR. Get it done. Cyclone Gabrielle could well have impacted the Whk district as it did Tairāwhiti & Hawkes Bay. Then what? Get real. Make a plan (with expert advice), and take disciplined, considered action.

Name:

Organisation (if on behalf of organisation)

How should we scale, fund and stage necessary upgrades to the Rex Morpeth Recreation Hub?

Option 2: Carry out redevelopment of the Rex Morpeth Recreation Hub as soon as possible. This requires us to secure 50% external funding for major development works in 2029 and 2030.

Your thoughts on how should we scale, fund and stage necessary upgrades to the Rex Morpeth Recreation Hub:

Such a well used facility. I'm undecided about the grandstand as this seems to have less use, but the rest of the facilities are in almost constant use for sports, shows, public etc.

How should we manage foodwaste collection?

Option 1: Mixed foodwaste and greenwaste for urban properties only.

Your thoughts on how we should manage foodwaste collection:

Would prefer not to have it - I compost. Not sure the carbon footprint of extra collections, potentially extra plastic bins can be countered via the limited nutrient gains of low value waste.

How quickly should we close our funding gap?

Option 2: Close the gap in the short-term (in three years) to avoid greater debt.

Your thoughts on closing our funding gap:

A year too late. Borrowing at times of high inflation and interest rates to avoid a rates increase is financial mismanagement. There are some potentially huge costs coming with 3 waters and climate change - now is not the time to be increasing debt to increase costs a few years down the line.

How should we distribute rates increases across the properties in our district?

Option 1: (Status quo) – 24% UAGC – \$927.50 (GST exclusive) in year 1.

Your thoughts on how we should distribute rates increases across the properties in our district:

Supporting document

N/A

Do you have any other feedback for your Mayor and Councillors?

Just try not to bow to the demands of a few. Community facilities are important unless you want to start killing off the town. I will be close to retirement once the recreation hub is complete and unlikely to get much use, however my kids, their friends all use it now and hopefully their kids will have something to use in the decades to come.

Name:

Organisation (if on behalf of organisation)

How should we scale, fund and stage necessary upgrades to the Rex Morpeth Recreation Hub?

Option 3: Carry out necessary upgrades to the Rex Morpeth Recreation Hub

Your thoughts on how should we scale, fund and stage necessary upgrades to the Rex Morpeth Recreation Hub:

Fancy sport facilities are notorious for cost blowouts. I doubt the current national government will contribute financially

How should we manage foodwaste collection?

Option 1: Mixed foodwaste and greenwaste for urban properties only.

Your thoughts on how we should manage foodwaste collection:

I support a weekly collection of compostable, and don't see a need for a seperate foodbin

How quickly should we close our funding gap?

Option 3: Close the gap in the medium-term (in six years) to ease the burden now.

Your thoughts on closing our funding gap:

How should we distribute rates increases across the properties in our district?

Option 3: 16% UAGC – \$559.13 (GST exclusive) in year 1.

Your thoughts on how we should distribute rates increases across the properties in our district:

Supporting document

N/A

Do you have any other feedback for your Mayor and Councillors?

Submission ID: 324

Date: Apr 06 24 01:54:28 pm

Name:

Margaret Dwen

Organisation (if on behalf of organisation) N/A

How should we scale, fund and stage necessary upgrades to the Rex Morpeth Recreation Hub?

Option 3: Carry out necessary upgrades to the Rex Morpeth Recreation Hub

Your thoughts on how should we scale, fund and stage necessary upgrades to the Rex Morpeth Recreation Hub:

Upgrade what's absolutely necessary regarding the Memorial Hall and Little Theatre. Toilet and changing facilities suitable for all. Modernise but nothing flashy regarding the rebuild. Keep it simple and fit for purpose. Subsidies, contributions, grants, naming rights, sponsors, fees, charges. Start on the most expensive stage especially with the pressures of inflation otherwise that budgeted amount is going to blow \$12.5m (\$3.1m subsidies & development contribution)

How should we manage foodwaste collection?

Option 1: Mixed foodwaste and greenwaste for urban properties only.

Your thoughts on how we should manage foodwaste collection:

Shared food waste collection and separate green waste collection for urban properties

How quickly should we close our funding gap?

Option 3: Close the gap in the medium-term (in six years) to ease the burden now.

Your thoughts on closing our funding gap:

How should we distribute rates increases across the properties in our district?

Option 2: 20% UAGC – \$741.31 (GST exclusive) in year 1.

Your thoughts on how we should distribute rates increases across the properties in our district:

I understand that rate rises are inevitable unless Central Government comes to the party and increases funding to Local Government, as long as they are distributed fairly and responsibly across the district.

Supporting document

N/A

Do you have any other feedback for your Mayor and Councillors?

Stick to Core Business 15% of the Operational Expenditure budget is for the water supply. I'm pleased about that because Clean water is essential. Lobby Central Government for support. Team up with our neighbouring Councils Opotiki, Kawerau to increase funding (The Coalition Government have thrown Councils under the bus ditching 3 Waters) I am not in support of a second bridge. I acknowledge the 2023 petition however, I refer to the The Ashburton Bridge (which is on a busy State Highway) that was partly washed out. They didn't get a second bridge and they would have had more cars going over it than Whakatane. They repaired the bridge. Or they build new bridges as they did down in Clive last year after Cyclone Gabrielle. The Boat Harbour - funding from WDC should be used for the marina and not other projects. Animal Control - Even though there is going to be an increase in levels of service regarding Animal Control, that is employing more dog rangers, obviously something is not working. Is more education needed around dog ownership and responsibilities? What do other councils do? How can WDC afford to have a Property Purchase Fund (Strategic Proportions) in this current economic climate? How

does WDC measure the strengthening relationship with Maori (Iwi, Hapu, Whanau)? How's that working out? Nga mihi ki a koutou katoa

Name:

Organisation (if on behalf of organisation)

How should we scale, fund and stage necessary upgrades to the Rex Morpeth Recreation Hub?

Your thoughts on how should we scale, fund and stage necessary upgrades to the Rex Morpeth Recreation Hub:

Maintenance as required only. No funding for upgrades until council is able to do so with high rates increases and not involved in borrowing dollars.

How should we manage foodwaste collection?

Your thoughts on how we should manage foodwaste collection:

Food waste is to be considered as personal and not be part of any waste collection apart from general rubbish collection currently in place. We need to eliminate waste as part of our home life, as we do daily.

How quickly should we close our funding gap?

Option 1: Close the gap quickly (in one year) so we pay less in the future.

Your thoughts on closing our funding gap:

There should be a budget in place to avoid any funding gap. Tighten belt like we have to.

How should we distribute rates increases across the properties in our district?

Option 3: 16% UAGC – \$559.13 (GST exclusive) in year 1.

Your thoughts on how we should distribute rates increases across the properties in our district:

Rates rises above 3% will mean we will have to consider selling up. It's impossible to continue on pension income. I don't want to move but it's is a reality for many.

Supporting document

N/A

Do you have any other feedback for your Mayor and Councillors?

No upgrades for Rex Morpeth, cease funding to strengthen ridiculous strengthening of Iwi and Maori relationships. We are all one, not separate entities. Stop the flood mitigation plan and deepening of river to be carried out. This flood mitigation wall is a total waste of my money. Environment bull such as carbon Emission's reduction is all a joke. Fear mongers destroying and manipulating people.

Name:

Organisation (if on behalf of organisation)

How should we scale, fund and stage necessary upgrades to the Rex Morpeth Recreation Hub?

Your thoughts on how should we scale, fund and stage necessary upgrades to the Rex Morpeth Recreation Hub:

Absolutely no upgrade, only ESSENTIONAL maintenance.. This Council needs to ensure we live within our means in the present economic climate.

How should we manage foodwaste collection?

Option 1: Mixed foodwaste and greenwaste for urban properties only.

Your thoughts on how we should manage foodwaste collection:

How quickly should we close our funding gap?

Option 3: Close the gap in the medium-term (in six years) to ease the burden now.

Your thoughts on closing our funding gap:

How should we distribute rates increases across the properties in our district?

Option 3: 16% UAGC – \$559.13 (GST exclusive) in year 1.

Your thoughts on how we should distribute rates increases across the properties in our district:

Supporting document

N/A

Do you have any other feedback for your Mayor and Councillors?

Submission ID: 327

Date: Apr 06 24 06:11:34 pm

Name:

Karen Melbourne

Organisation (if on behalf of organisation)

How should we scale, fund and stage necessary upgrades to the Rex Morpeth Recreation Hub?

Option 3: Carry out necessary upgrades to the Rex Morpeth Recreation Hub

Your thoughts on how should we scale, fund and stage necessary upgrades to the Rex Morpeth Recreation Hub:

Fund it remembering that most people don't want anymore wasteful extravagant spending.

How should we manage foodwaste collection?

Option 1: Mixed foodwaste and greenwaste for urban properties only.

Your thoughts on how we should manage foodwaste collection:

Separate food waste costs extra which we don't have and the bins are pathetically small to small for a normal family

How quickly should we close our funding gap?

Option 3: Close the gap in the medium-term (in six years) to ease the burden now.

Your thoughts on closing our funding gap:

Stop extravagant spending , do it once do it properly, example the pool complex

How should we distribute rates increases across the properties in our district?

Option 3: 16% UAGC – \$559.13 (GST exclusive) in year 1.

Your thoughts on how we should distribute rates increases across the properties in our district:

Areas like Ohope etc should pay their share not be discounted by the poorer areas, all Taneatua gets is trucks

Supporting document

N/A

Do you have any other feedback for your Mayor and Councillors?

You have spent and wasted to much of our money and want to waste more, enough us enough

Submission ID: 328

Date: Apr 07 24 07:07:26 am

Name:

Asheley Herring

Organisation (if on behalf of organisation)

How should we scale, fund and stage necessary upgrades to the Rex Morpeth Recreation Hub?

Option 3: Carry out necessary upgrades to the Rex Morpeth Recreation Hub

Your thoughts on how should we scale, fund and stage necessary upgrades to the Rex Morpeth Recreation Hub:

I appreciate building's need to be kept and money spent on maintaining them or it costs more in the future. Why does it need redevelopment? Let's maintain it and enjoy it as is. I'm not going to use a flashed up hub more then I use the park the park now.

How should we manage foodwaste collection?

Option 1: Mixed foodwaste and greenwaste for urban properties only.

Your thoughts on how we should manage foodwaste collection:

By splitting it out your relying on people doing it correctly. I go to the dump and recycle on a regular bases even with clearly labeled bins and making the effort to actually go and recycle idiots still cant do it right. Wrong coloured bottles in the glass bins and the wrong plastic? Some people will just never care.

How quickly should we close our funding gap?

Option 2: Close the gap in the short-term (in three years) to avoid greater debt.

Your thoughts on closing our funding gap:

Closing the funding gap for everyday services is more important then a sports hub.

How should we distribute rates increases across the properties in our district?

Option 2: 20% UAGC – \$741.31 (GST exclusive) in year 1.

Your thoughts on how we should distribute rates increases across the properties in our district:

I don't understand the information option 3 is less but the increase \$\$ in my sector is more?? So I've gone with the councils perfered option I'm trusting u to do what is right. Just remember we are a hard working family 2 adults and 2 primary kids and are are only just making ends meet. I understand everyones incl the councils cost have increased so please spend it wisely across the board and not just on pet projects. We need a new bridge first and foremost that will beifit the whole community and yes you are going to do this but we all know it will probably run over time and costs and I'd rather pay the extra to this.

Supporting document

N/A

Do you have any other feedback for your Mayor and Councillors?

Just remember your working for all the community not just special groups. It's a thankless job and I don't envy you.

Submission ID: 329

Date: Apr 07 24 09:09:11 am

Name:

Chris and Gaye Moyes

Organisation (if on behalf of organisation)

How should we scale, fund and stage necessary upgrades to the Rex Morpeth Recreation Hub?

Option 3: Carry out necessary upgrades to the Rex Morpeth Recreation Hub

Your thoughts on how should we scale, fund and stage necessary upgrades to the Rex Morpeth Recreation Hub:

Important to retain and upgrade existing facility as needed but not to rebuild or replace

How should we manage foodwaste collection?

Option 1: Mixed foodwaste and greenwaste for urban properties only.

Your thoughts on how we should manage foodwaste collection:

How quickly should we close our funding gap?

Your thoughts on closing our funding gap:

Unable to answer without more detailed knowledge

How should we distribute rates increases across the properties in our district?

Option 3: 16% UAGC – \$559.13 (GST exclusive) in year 1.

Your thoughts on how we should distribute rates increases across the properties in our district:

Supporting document

N/A

Do you have any other feedback for your Mayor and Councillors?

Please do NOT cut back on gardening staff and flowerbeds - they are a major contributor to making town feel a good place to live. Please congratulate gardening staff on wonderful job they have done over the years!

Name:**Organisation (if on behalf of organisation)****How should we scale, fund and stage necessary upgrades to the Rex Morpeth Recreation Hub?****Your thoughts on how should we scale, fund and stage necessary upgrades to the Rex Morpeth Recreation Hub:**

NONE OF THE ABOVE I don't believe that this is essential work and as so many people are currently struggling financially I do not think now is the time to undertake this work - and seriously showing rates increases per week as opposed to per year which is what is most relevant for the majority of people feels somewhat less than transparent - you don't show an option that doesn't include nice to have extras such as the playground, car parking etc so labelling Option 3 As necessary upgrades once again is not transparent communication

How should we manage foodwaste collection?**Your thoughts on how we should manage foodwaste collection:**

NONE OF THE ABOVE Thank you for quoting annual costs on these services. As I am rural this does not apply to me however I note the suggestion of free worm farms for rural properties so am somewhat concerned that I am contributing to this scheme. I feel there should be an option that excludes the offer of free worm farms to rural properties as in my opinion most don't require this and it would be an added cost - rural properties should pay for own worm farm and contribute less to the waste scheme

How quickly should we close our funding gap?**Your thoughts on closing our funding gap:**

I can see the sense in getting rid of the current debt but my concern is again that people just can't afford it and with little confidence that Council won't curb future spending. I feel that this opens the door for a level of financial comfort on Council that I am hesitant on so I would like to see LTP's that don't go overboard before committing to anything other than long term which is not an option currently

How should we distribute rates increases across the properties in our district?

Option 3: 16% UAGC – \$559.13 (GST exclusive) in year 1.

Your thoughts on how we should distribute rates increases across the properties in our district:

IF UAGC is a flat rate regardless of property value then how come ...Charging a higher UAGC increases the overall rates on lower value properties and decreases the overall rates on higher value properties. Moving the UAGC number down means that those in lower-value properties are likely to pay a lesser amount in total.....not well explained

Supporting document

N/A

Do you have any other feedback for your Mayor and Councillors?

Please listen to what the average Whakatane-ite is telling you - mostly we are struggling. We want to be able to live in a town we love that should provide easy access (yes we do need a second bridge) and is liveable - we don't need or want excessive 'nice to haves' to make the town pretty for others

Submission ID: 331

Date: Apr 07 24 12:16:22 pm

Name:

Linda Rowbotham

Organisation (if on behalf of organisation)

How should we scale, fund and stage necessary upgrades to the Rex Morpeth Recreation Hub?

Option 3: Carry out necessary upgrades to the Rex Morpeth Recreation Hub

Your thoughts on how should we scale, fund and stage necessary upgrades to the Rex Morpeth Recreation Hub:

Any repairs which need to be completed for safety reasons must be a priority. ie. seismic strengthening of the rugby grandstand. It is also important that the War Memorial Hall is brought up to a good workable standard, without a full scale rebuild, so a budget needs to be adhered to. We have seen, all too often, architects getting carried away with plans and putting forward grandiose ideas. Don't allow this to happen. Stick to the basics on all the work required to make Rex Morpeth Recreation Hub a good space for all to share on a budget that recognizes the financial hard times many ratepayers are going through at present.

How should we manage foodwaste collection?

Option 1: Mixed foodwaste and greenwaste for urban properties only.

Your thoughts on how we should manage foodwaste collection:

I don't believe the government policy which has to be put in place before 1st January '27 is feasible. We compost at home and so don't put many food scraps in the general waste. Perhaps the government and council should revisit this policy and consider teaching people how to compost, and grow their own vegetables at home. Even on a small property, there is the potential to grow veges in an old car tyre. There is always an issue with a separate food scrap bucket of where to put it so it is handy when preparing meals. I'm not happy about paying extra and having the general rubbish only taken once a fortnight. There are a lot of families who fill the general rubbish bin to overflowing each week, so I'm unsure how they will cope.

How quickly should we close our funding gap?

Option 3: Close the gap in the medium-term (in six years) to ease the burden now.

Your thoughts on closing our funding gap:

We are in a recession. Now is NOT the time to try to close the funding gap quickly. Now is the time for all people and businesses to make cuts on spending. I don't trust that the next few years increases stated in the booklet will be kept to the budget, even if it was agreed to have a larger increase this financial. There must be ways of reducing spending at all levels of government / council, without taking a lot away from the basics required to keep the towns and cities clean and working. Employ local people to assist with general maintenance around the towns, instead of people having to travel out of town, to keep costs down.

How should we distribute rates increases across the properties in our district?

Option 2: 20% UAGC – \$741.31 (GST exclusive) in year 1.

Your thoughts on how we should distribute rates increases across the properties in our district:

The average sized farming and horticulture sectors have been doing it tougher than most residential property owners recently, so it is unfair for them to bare the brunt of larger increases on their rates. So I

am happy to support the slightly larger increase for the residential areas, as we need farmers to feed us and for the economy to be healthier.

Supporting document

N/A

Do you have any other feedback for your Mayor and Councillors?

In Matata there are a lot of lower paid people and pensioners, who can't afford to have the rates increases that are being thrown around at present. People shouldn't be forced out of their own homes, just because they can't afford to pay their rates. However we need the mains wastewater system to proceed, so understand there are going to be costs involved for this upgrade. There has been a lot of money spent over the past 10 years or more, on consultation and testing and now the project is apparently at a point of almost being ready for a consent process. So it troubles me to hear that some members of Council may believe there is 'not enough scientific evidence' to see the need for the project to proceed in the very near future. I have a letter from Nanaia Mahuta, who was Minister of Local Government in 2018, stating that the government are aware there is a NEED for reticulated sewerage in Matata, and she also stated that the government is committed to assisting local councils in providing safe wastewater systems, so surely there is a case for this to go higher if our local District and Regional Councils don't have the funds to make it happen. If there is capacity for the Kawerau Treatment Plant to take our waste water, why hasn't it been discussed in more depth, if this would be a less expensive option? The health and wellbeing of our town is at risk if we don't get reticulated sewerage in the near future, so this needs to happen very soon. This is a priority for our community.

Submission ID: 332

Date: Apr 07 24 02:44:47 pm

Name:

Chris Burn

Organisation (if on behalf of organisation)

How should we scale, fund and stage necessary upgrades to the Rex Morpeth Recreation Hub?

Option 3: Carry out necessary upgrades to the Rex Morpeth Recreation Hub

Your thoughts on how should we scale, fund and stage necessary upgrades to the Rex Morpeth Recreation Hub:

Maintenance of existing Hub is all that is required in these hard financial times.

How should we manage foodwaste collection?

Your thoughts on how we should manage foodwaste collection:

What would work????

How quickly should we close our funding gap?

Option 3: Close the gap in the medium-term (in six years) to ease the burden now.

Your thoughts on closing our funding gap:

Obvious in todays hard financial times.

How should we distribute rates increases across the properties in our district?

Option 3: 16% UAGC – \$559.13 (GST exclusive) in year 1.

Your thoughts on how we should distribute rates increases across the properties in our district:

What people can afford.

Supporting document

N/A

Do you have any other feedback for your Mayor and Councillors?

Please talk to the people who are struggling and what effect your decisions will on their lives!!!!!!

Name:

Organisation (if on behalf of organisation) N/A

How should we scale, fund and stage necessary upgrades to the Rex Morpeth Recreation Hub?

Option 3: Carry out necessary upgrades to the Rex Morpeth Recreation Hub

Your thoughts on how should we scale, fund and stage necessary upgrades to the Rex Morpeth Recreation Hub:

Not sure

How should we manage foodwaste collection?

Option 3: Separate foodwaste collection for all properties.

Your thoughts on how we should manage foodwaste collection:

Public should compost their foodwaste.

How quickly should we close our funding gap?

Option 3: Close the gap in the medium-term (in six years) to ease the burden now.

Your thoughts on closing our funding gap:

Not such a big increase in our rates

How should we distribute rates increases across the properties in our district?

Option 3: 16% UAGC – \$559.13 (GST exclusive) in year 1.

Your thoughts on how we should distribute rates increases across the properties in our district:

I feel for the farmers in our district as they pay very high rates and what do they receive.....

Supporting document

N/A

Do you have any other feedback for your Mayor and Councillors?

We have been waiting over twenty years for Matata sewerage, which is crucial for Matata, we require a reticulated sewerage scheme immediately. If we go into a maintenance zone, what's that going to cost, to buy out sixty homes, most likely the same as a reticulated scheme.

Name:

Organisation (if on behalf of organisation)

How should we scale, fund and stage necessary upgrades to the Rex Morpeth Recreation Hub?

Option 2: Carry out redevelopment of the Rex Morpeth Recreation Hub as soon as possible. This requires us to secure 50% external funding for major development works in 2029 and 2030.

Your thoughts on how should we scale, fund and stage necessary upgrades to the Rex Morpeth Recreation Hub:

I think the war memorial should be rebuilt because its getting to old. and we can use the left over money in better infrastructure to help with our traffic problem in the town. Instead of it going into new sporting facilities as they can come later in the future.

How should we manage foodwaste collection?

Option 1: Mixed foodwaste and greenwaste for urban properties only.

Your thoughts on how we should manage foodwaste collection:

Don't no

How quickly should we close our funding gap?

Option 2: Close the gap in the short-term (in three years) to avoid greater debt.

Your thoughts on closing our funding gap:

don't no

How should we distribute rates increases across the properties in our district?

Option 3: 16% UAGC – \$559.13 (GST exclusive) in year 1.

Your thoughts on how we should distribute rates increases across the properties in our district:

don't no

Supporting document

Attached

Do you have any other feedback for your Mayor and Councillors?

add paid showers at public toilets like the ones in Napier.

Kakahoroa dr walkway and cafe garden project



Introduction:

My name is [REDACTED] a local resident and My idea is that you should convert the burnt down building located on 88 the strand Into a garden area with a glass roof on top and behind the building is a walkway going to Kakahoroa Dr and following it up to the warehouse. In the garden area could have a cafe where the public could relax and enjoy the surroundings of the garden. Having a garden would benefit the environment and tourism by giving the surrounding place a nicer and more inviting place to be at. And by keeping the remains of the front of the building will keep its historical value of the area. For the cafe there could be a second floor where people can enjoy the view of the river.

Photos of the site and what it looks like:



Birds eye view of the site:

On the bird's eye view The black lines show the area of the walkway and the yellow line is the area of the garden/cafe.



The road would slightly need to be redesigned to fit with the walkway and its crossing for it to work. And there would be a new redesign of the existing walkway that's between the road and river. On page 6 to 7 will show a concept design model of the road and walkway that I have done. And also the redesign of the waterfront walkway.

What I imagine the waterfront walkway would look like is there would be street lamps, palm trees and a bike lane going along it. And between the road and the new walkway would be new street lights. There would also be some sort of sculper like structure in between the car park and the T section road to make the area have more to look at.

Inspirational photos of other walkway areas in different places:

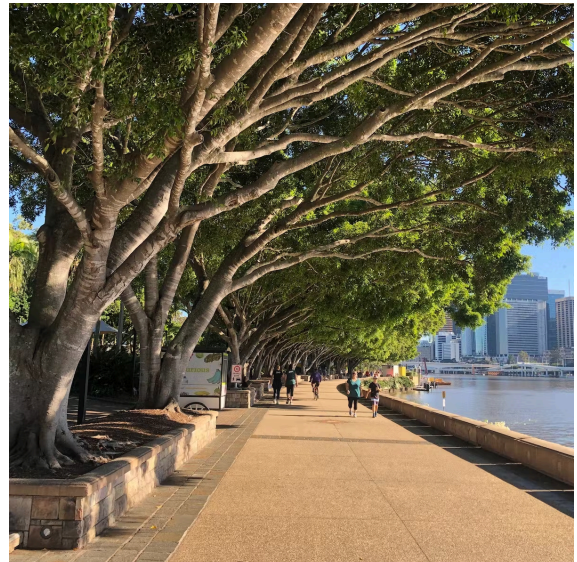

Research on street lamps and light pollution:

For the street lamps I will research on what ones are best for the walkway and what ones prevent light pollution to make it better for the environment.

This image shows what lamps a good or bad for light pollution

You could also add sensor lights that when you walk nearby it will light up brighter and when you walk away it will go dimmer. This would make it more energy efficient as when there is no one around the lights when dimmed will be using less power.



Palm trees:

The palm trees I would use are nikau trees. There are a few reasons for using this type of palm tree. one of them is that it suits well in the area as it gives a tropical beach vibe with Whakatane warm sunny climate. It would make many people feel like being in a tropical township similar to places like Hawaii or the caribbean. Another thing that would benefit with the nikau trees is our environment, such as the endangered native wood pigeon that eat the berries that the nikau trees produce as a food source. In theory adding nikau trees could help boost the population of the wood pigeon.



Glass rooftop:

On the top of the cafe would be a big glass roof to allow viewing of the sky and protection from all weather elements. As well the glass roof would allow lots of natural light in allowing less reliant on lights, making the building more energy efficient. The glass could be low e glass that has protection against harmful uv radiation from the sun allowing people to be up stairs without getting sunburnt especially during the summer.

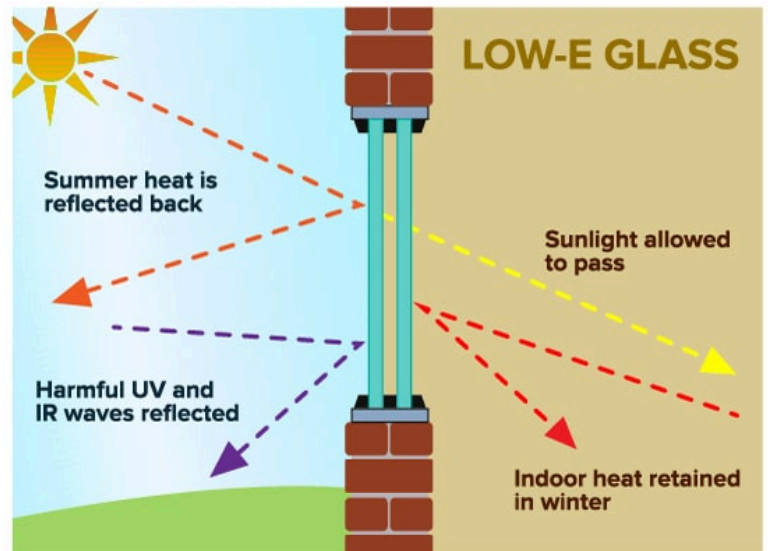

Recycled Plastic walkway and roading:

In the road and including the new walk way you could look into by making them out of plastic a similar concept has been done in the Netherlands where bike lanes are made from recycled plastic that's moulded into different sections then placed together like a jigsaw puzzle. Doing this would be quite good as it is cheap because you are recycling used plastic that also benefits the environment and also it's easy to replace as it's in sections meaning you just take the old part out and fit in a new piece. This makes mantins on walkways and roads much faster, efficient, and cheaper at the same time.



Concept model done on sketchup:

View of the entire concept.

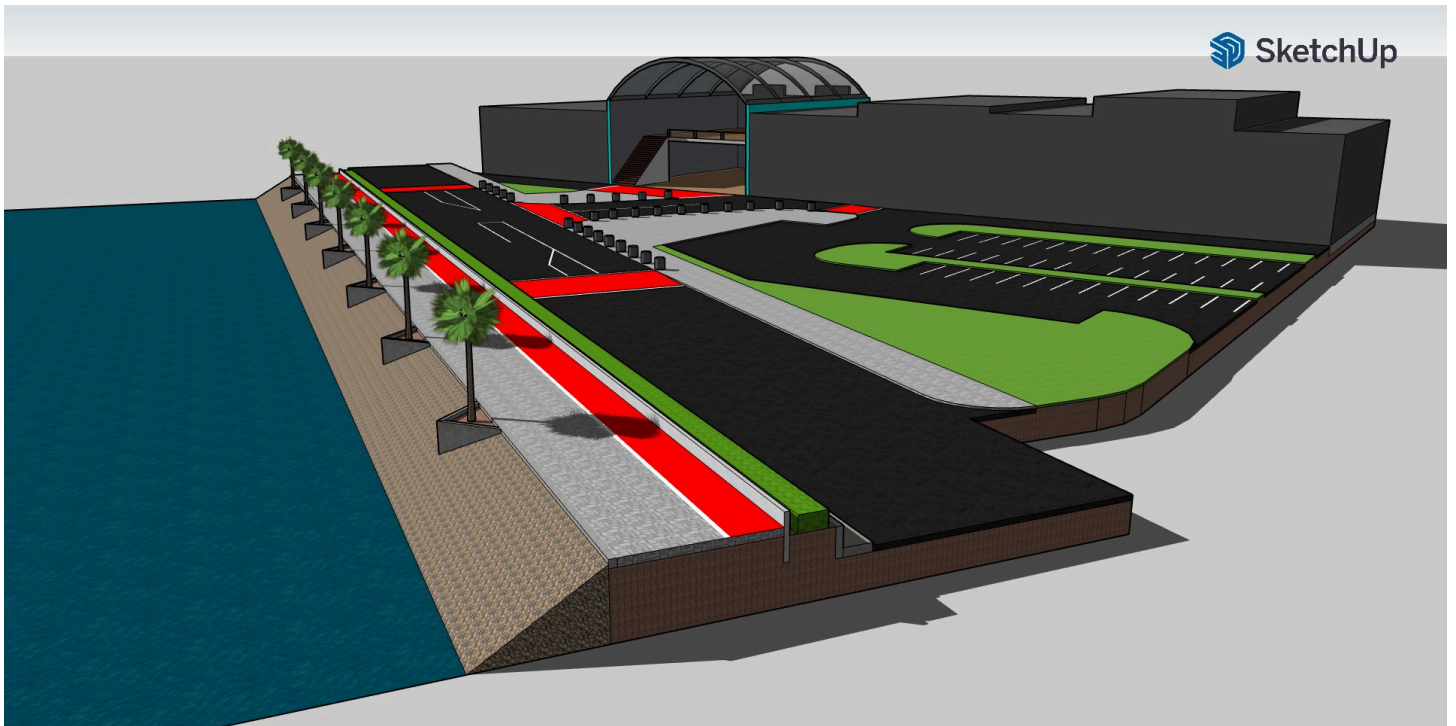

View from up steers of the cafe looking out towards the river.

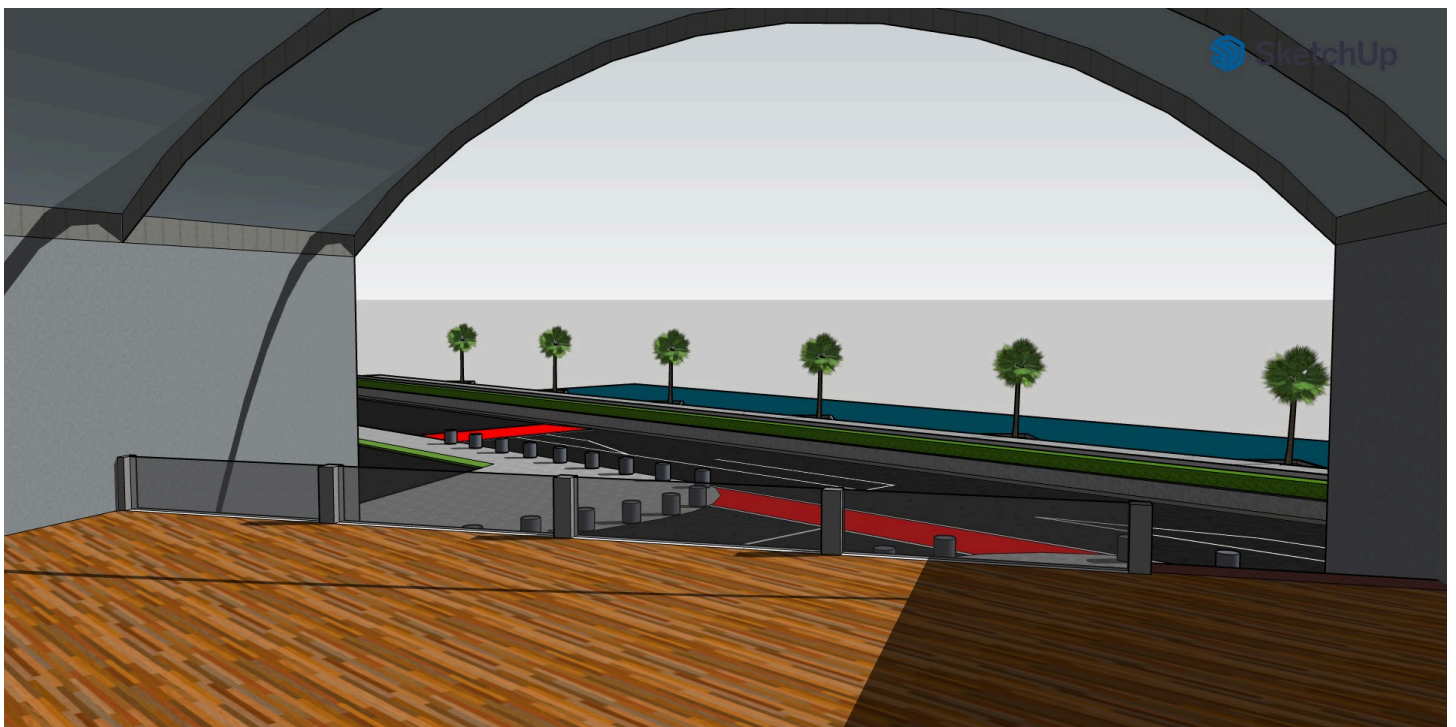

Glass roof enabling to view the sky at all times of the day in all weather, giving uv protection.

View of the parking lot entrance and on the left of the path would be the spot of some sort of sculpture.

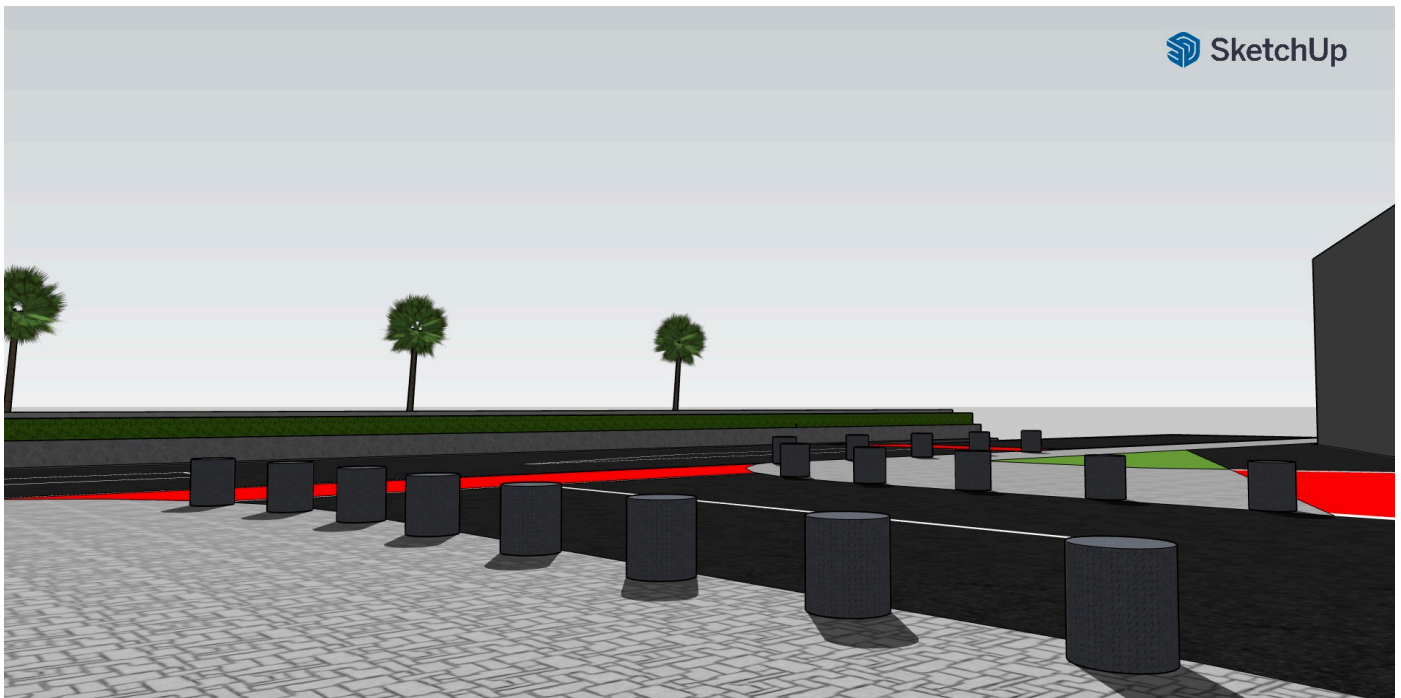

View from the waterfront walkway looking towards the cafe.

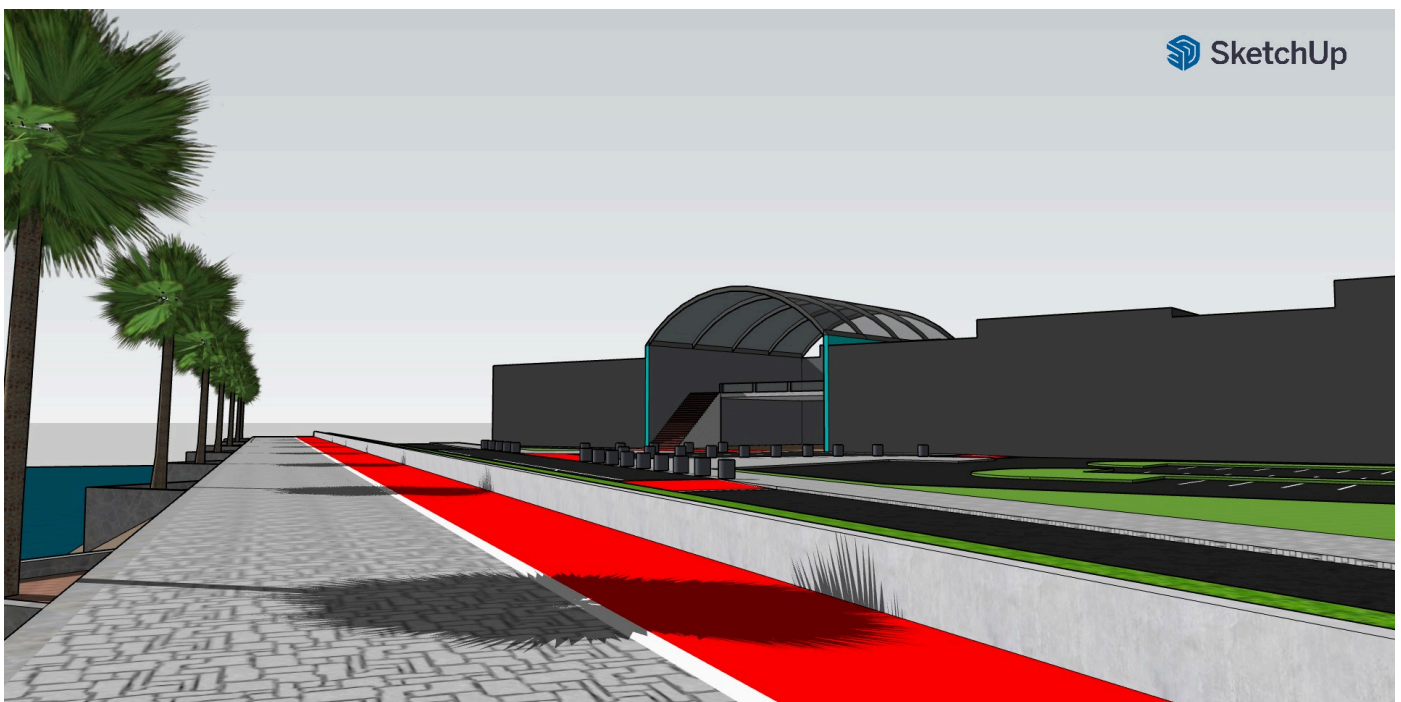

In the design I have added bollards along the side of the road where the footpath and road are at the same level to prevent vehicles driving on the path causing accidents. As well along the new redesign of the riverfront walkway I've added a bike lane and palm trees along that would be nikau trees.

The benefits of the concept will bring:

Community:

This would benefit the community as the cafe would be a place where people can relax and get a coffee, socialising, and a place where business and project planning could be discussed and Extra.

Wellbeing for people:

This would be good for the wellbeing for people in the community, as it will encourage people to go outside more often and socialise. Allowing people to get more exercise and become more healthier as they would be going out walking or biking more often.

Environment:

This would be good to the environment as it incorporates nature in the cafe such as plants and the nikau palm trees good for our local wildlife. Such as the wood pigeon and bird life.

Tourism:

This would increase tourism by allowing visitors and tourists to enjoy themselves here by going nice walks or bike rides enabling people to relax in the garden cafe while overlooking the scenic river watching the boats go by. This helps make some people want to live here.

Overall I believe that this idea would be well suited for the town and will be enjoyed by the community and visitors to the town.

Kind regards

[Redacted signature]

[Redacted address]

Submission ID: 335

Date: Apr 07 24 07:57:49 pm

Name:

Dr Robin Lane

Organisation (if on behalf of organisation)

Music Whakatane

How should we scale, fund and stage necessary upgrades to the Rex Morpeth Recreation Hub?

Option 3: Carry out necessary upgrades to the Rex Morpeth Recreation Hub

Your thoughts on how should we scale, fund and stage necessary upgrades to the Rex Morpeth Recreation Hub:

There is an urgent need for immediate fixing of H and S issues with the Little Theatre. These need to be done very soon - rainwater sealing, and sealing of any asbestos issues. The rest has to wait til the town is in a better place financially. There are more urgent infrastructure issues elsewhere.

How should we manage foodwaste collection?

Option 1: Mixed foodwaste and greenwaste for urban properties only.

Your thoughts on how we should manage foodwaste collection:

If the technology is there to compost the mixture then do that. If not, then a separate collection is needed.

How quickly should we close our funding gap?

Option 3: Close the gap in the medium-term (in six years) to ease the burden now.

Your thoughts on closing our funding gap:

How should we distribute rates increases across the properties in our district?

Option 1: (Status quo) – 24% UAGC – \$927.50 (GST exclusive) in year 1.

Your thoughts on how we should distribute rates increases across the properties in our district:

The people who get more pay more. Except the poorer areas of town. They should get the same services but have a way to reduce their rates - Community services card rebates.

Supporting document

N/A

Do you have any other feedback for your Mayor and Councillors?

Fix the infrastructure and do the minimum on the nice ones. Scrap all public funding for the new marina - it's a no-brainer that it will be a bottomless sink for money, with hardly any value returned to the town..

Name:

Organisation (if on behalf of organisation)

How should we scale, fund and stage necessary upgrades to the Rex Morpeth Recreation Hub?

Option 3: Carry out necessary upgrades to the Rex Morpeth Recreation Hub

Your thoughts on how should we scale, fund and stage necessary upgrades to the Rex Morpeth Recreation Hub:

We should do the upgrades only, and only if we can afford it.

How should we manage foodwaste collection?

Your thoughts on how we should manage foodwaste collection:

Do not do this at all, tell the government we can't afford it, and get people to compost their own waste

How quickly should we close our funding gap?

Your thoughts on closing our funding gap:

Decrease the funding gap by spending less like the rest of us.

How should we distribute rates increases across the properties in our district?

Your thoughts on how we should distribute rates increases across the properties in our district:

Supporting document

N/A

Do you have any other feedback for your Mayor and Councillors?

The funding model is broken but you continue using it. Local councils rates increases are a cause of inflation. Need to budget less and spend less like the rest of us, just provide less services. Stop spending and acting like a big council, we can't afford it. Decrease spending on policy, use more on delivery, ie. less talk, more action. Justifying spending by saying this is what people want isn't working, just do what we need and can afford. Reduce/reject compliance demands from Central Government. Projected debt keeps on increasing, and then miraculously levels off after 5 years? Unlikely. Debt needs to be addressed, it appears that debt is not being used to fund significant infrastructure, just accumulating as a result of cost overruns. It will continue to increase and become unmanageable, which is irresponsible. Stop funding Climate Change mitigation policy, there is no emergency or existential threat. Focus on environment and pollution without the hysteria.

Name:

Organisation (if on behalf of organisation)

How should we scale, fund and stage necessary upgrades to the Rex Morpeth Recreation Hub?

Option 3: Carry out necessary upgrades to the Rex Morpeth Recreation Hub

Your thoughts on how should we scale, fund and stage necessary upgrades to the Rex Morpeth Recreation Hub:

Necessary repairs only. Everyone has added pressure in the last few years each month there is a new email with price raises for petrol, power, internet, insurances, food, interest rates etc. This is not the time to be doing major redevelopmens

How should we manage foodwaste collection?

Your thoughts on how we should manage foodwaste collection:

How quickly should we close our funding gap?

Your thoughts on closing our funding gap:

How should we distribute rates increases across the properties in our district?

Your thoughts on how we should distribute rates increases across the properties in our district:

All options ridiculous. The cost of living is excessive at the moment and nothing has yet stabilised. I have lived here almost 40years and this is now making my family seriously considering leaving. It is becoming less feasible to stay and raise our family here. Projects as excessive should be reconsidered once the recession is over

Supporting document

N/A

Do you have any other feedback for your Mayor and Councillors?

Name:

Organisation (if on behalf of organisation)

How should we scale, fund and stage necessary upgrades to the Rex Morpeth Recreation Hub?

Option 3: Carry out necessary upgrades to the Rex Morpeth Recreation Hub

Your thoughts on how should we scale, fund and stage necessary upgrades to the Rex Morpeth Recreation Hub:

Least cost to ratepayers

How should we manage foodwaste collection?

Option 1: Mixed foodwaste and greenwaste for urban properties only.

Your thoughts on how we should manage foodwaste collection:

Least cost to ratepayers

How quickly should we close our funding gap?

Option 3: Close the gap in the medium-term (in six years) to ease the burden now.

Your thoughts on closing our funding gap:

I actually do not like any options

How should we distribute rates increases across the properties in our district?

Option 3: 16% UAGC – \$559.13 (GST exclusive) in year 1.

Your thoughts on how we should distribute rates increases across the properties in our district:

Lowest cost to ratepayers

Supporting document

N/A

Do you have any other feedback for your Mayor and Councillors?

Can other costs not be cut elsewhere in operating costs? Every bit helps. Staff salaries look huge with a large portion on six figures? Why? It is never good to lose your job but have staff been reviewed on performance outcomes, do you really need that many staff in high paying jobs that could possibly be outsourced for a lot less? Are there any assets, land the council could sell to generate more funds, lessening the load on ratepayers? Please look at the budget and see where more costs could be made.

Name:

Organisation (if on behalf of organisation)

How should we scale, fund and stage necessary upgrades to the Rex Morpeth Recreation Hub?

Option 2: Carry out redevelopment of the Rex Morpeth Recreation Hub as soon as possible. This requires us to secure 50% external funding for major development works in 2029 and 2030.

Your thoughts on how should we scale, fund and stage necessary upgrades to the Rex Morpeth Recreation Hub:

How should we manage foodwaste collection?

Option 2: Separate foodwaste collection for urban properties only.

Your thoughts on how we should manage foodwaste collection:

How quickly should we close our funding gap?

Option 3: Close the gap in the medium-term (in six years) to ease the burden now.

Your thoughts on closing our funding gap:

How should we distribute rates increases across the properties in our district?

Option 2: 20% UAGC – \$741.31 (GST exclusive) in year 1.

Your thoughts on how we should distribute rates increases across the properties in our district:

Supporting document

N/A

Do you have any other feedback for your Mayor and Councillors?

Submission ID: 340

Date: Apr 08 24 10:33:07 am

Name:

Barrie Hawkes

Organisation (if on behalf of organisation)

How should we scale, fund and stage necessary upgrades to the Rex Morpeth Recreation Hub?

Option 3: Carry out necessary upgrades to the Rex Morpeth Recreation Hub

Your thoughts on how should we scale, fund and stage necessary upgrades to the Rex Morpeth Recreation Hub:

Or option 4. Leave Rex Morpeth alone!

How should we manage foodwaste collection?

Your thoughts on how we should manage foodwaste collection:

Or option 4. No food waste collection.

How quickly should we close our funding gap?

Option 3: Close the gap in the medium-term (in six years) to ease the burden now.

Your thoughts on closing our funding gap:

How should we distribute rates increases across the properties in our district?

Your thoughts on how we should distribute rates increases across the properties in our district:

Supporting document

Attached

Do you have any other feedback for your Mayor and Councillors?

Please sort out the sewerage at Matata.

WHAKATĀNE DISTRICT COUNCIL LONG TERM PLAN 2024-34 - SUBMISSION FORM

Name*: Barrie Hawkes
 Town/area of the district*: Matata 
 Organisation (if on behalf):

*Privacy note: The information on this page (including fields above) forms part of your submission and will be made publicly available on a Council meeting agenda. Please leave any fields blank if you do not want this to be available on a public meeting agenda.

<p>How should we scale, fund and stage necessary upgrades to the Rex Morpeth Recreation Hub?</p>	<p><input type="checkbox"/> Option 1: Carry out redevelopment of the Rex Morpeth Recreation Hub as soon as possible. This requires us to secure 35% external funding for major development works in 2028 and 2029.</p> <p><input type="checkbox"/> Option 2: Carry out redevelopment of the Rex Morpeth Recreation Hub as soon as possible. This requires us to secure 50% external funding for major development works in 2029 and 2030.</p> <p><input checked="" type="checkbox"/> Option 3: Carry out necessary upgrades to the Rex Morpeth Recreation Hub</p>	<p>Your thoughts</p> <p>Or Option 4 Leave Rex Morpeth Park alone!</p>
<p>How should we manage foodwaste collection?</p>	<p><input type="checkbox"/> Option 1: Mixed foodwaste and greenwaste for urban properties only.</p> <p><input type="checkbox"/> Option 2: Separate foodwaste collection for urban properties only.</p> <p><input type="checkbox"/> Option 3: Separate foodwaste collection to all properties.</p>	<p>Your thoughts</p> <p>or Option 4 No foodwaste collection!</p>
<p>How quickly should we close our funding gap?</p>	<p><input type="checkbox"/> Option 1: Close the gap quickly (in one year) so we pay less in the future.</p> <p><input type="checkbox"/> Option 2: Close the gap in the short term (in three years) to avoid greater debt.</p> <p><input checked="" type="checkbox"/> Option 3: Close the gap in the medium term (in six years) to ease the burden now.</p>	<p>Your thoughts</p>
<p>How should we distribute rates increases across the properties in our district?</p>	<p><input type="checkbox"/> Option 1: (Status quo) – 24% UAGC – \$927.50 (GST exclusive) in year 1.</p> <p><input type="checkbox"/> Option 2: 20% UAGC – \$741.31 (GST exclusive) in year 1.</p> <p><input type="checkbox"/> Option 3: 16% UAGC – \$559.13 (GST exclusive) in year 1.</p>	<p>Your thoughts</p>

Please sort out the ~~san~~ sewage at Matata

Need more space for your feedback?

Please add more pages and make sure your name and organisation (if relevant) are at the top of each page.

Submission ID: 341

Date: Apr 08 24 10:35:28 am

Name:

Albert Hulse

Organisation (if on behalf of organisation)

How should we scale, fund and stage necessary upgrades to the Rex Morpeth Recreation Hub?

Your thoughts on how should we scale, fund and stage necessary upgrades to the Rex Morpeth Recreation Hub:

Do nothing at all. Everyone is sick of Council wasting ratepayer money. Why don't the Council listen to the ratepayer.

How should we manage foodwaste collection?

Option 1: Mixed foodwaste and greenwaste for urban properties only.

Your thoughts on how we should manage foodwaste collection:

Sick of rate rises every year. People can not keep paying these increases.

How quickly should we close our funding gap?

Your thoughts on closing our funding gap:

How should we distribute rates increases across the properties in our district?

Option 3: 16% UAGC – \$559.13 (GST exclusive) in year 1.

Your thoughts on how we should distribute rates increases across the properties in our district:

Supporting document

Attached

Do you have any other feedback for your Mayor and Councillors?

WHAKATĀNE DISTRICT COUNCIL LONG TERM PLAN 2024-34 - SUBMISSION FORM

Name*: Albert Hula

Town/area of the district*: Whakatane

Organisation (if on behalf): _____

**Privacy note: The information on this page (including fields above) forms part of your submission and will be made publicly available on a Council meeting agenda. Please leave any fields blank if you do not want this to be available on a public meeting agenda.*

<p>How should we scale, fund and stage necessary upgrades to the Rex Morpeth Recreation Hub?</p>	<p><input type="checkbox"/> Option 1: Carry out redevelopment of the Rex Morpeth Recreation Hub as soon as possible. This requires us to secure 35% external funding for major development works in 2028 and 2029.</p> <p><input type="checkbox"/> Option 2: Carry out redevelopment of the Rex Morpeth Recreation Hub as soon as possible. This requires us to secure 50% external funding for major development works in 2029 and 2030.</p> <p><input type="checkbox"/> Option 3: Carry out necessary upgrades to the Rex Morpeth Recreation Hub</p>	<p>Your thoughts</p> <p><u>Do the nothing at all. Everyone is sick of council wasting rate payer money. Why Don't the council listen to rate payer!</u></p>
<p>How should we manage foodwaste collection?</p>	<p><input checked="" type="checkbox"/> Option 1: Mixed foodwaste and greenwaste for urban properties only.</p> <p><input type="checkbox"/> Option 2: Separate foodwaste collection for urban properties only.</p> <p><input type="checkbox"/> Option 3: Separate foodwaste collection to all properties.</p>	<p>Your thoughts</p> <p><u>Sick of rate rises every year. People can not keep</u></p>
<p>How quickly should we close our funding gap?</p>	<p><input type="checkbox"/> Option 1: Close the gap quickly (in one year) so we pay less in the future.</p> <p><input type="checkbox"/> Option 2: Close the gap in the short term (in three years) to avoid greater debt.</p> <p><input type="checkbox"/> Option 3: Close the gap in the medium term (in six years) to ease the burden now.</p>	<p>Your thoughts</p> <p><u>Paying these increases.</u></p>
<p>How should we distribute rates increases across the properties in our district?</p>	<p><input type="checkbox"/> Option 1: (Status quo) – 24% UAGC – \$927.50 (GST exclusive) in year 1.</p> <p><input type="checkbox"/> Option 2: 20% UAGC – \$741.31 (GST exclusive) in year 1.</p> <p><input checked="" type="checkbox"/> Option 3: 16% UAGC – \$559.13 (GST exclusive) in year 1.</p>	<p>Your thoughts</p>

Need more space for your feedback?

Please add more pages and make sure your name and organisation (if relevant) are at the top of each page.